

ListenTALK Docking Station Quick Start Guide

Introduction

Thank you for purchasing the ListenTALK Docking Station! For additional details on use, adjustment, or programming, download the full ListenTALK Operations Manual from www.listentech.com/support/manuals. To purchase accessories, visit: www.listentech.com/shop-listen.

**Docking
Station 16**
LA-480



**Docking
Station Case 16**
LA-481

Position and Connect the Docking Station

Docking Station 16 – Place on a flat surface or mount on a wall or other surface using the *Wall-Mounting Slots* on the back.

Docking Station Case – Place on a flat surface.

Connect – Connect the *Power Supply* to the Docking Station *Power Connector* and the Power Cord to any standard AC outlet (110/220 VAC, 50/60 Hz). Optionally, connect the Docking Station's USB Port to a Windows computer equipped with the ListenTALK Software Suite.

Charge ListenTALK Transceivers

Insert ListenTALK Transceivers into Docking Station pockets. The Transceiver Status Indicator will flash indicating the battery is charging and turn solid when fully charged.

Create a Group with Docking Station

Create a *Leader* and optional *Sub-Leader(s)* by inserting red *Leader Clips* onto Transceivers. Place the Leader into the *Leader Pocket*. Place other Transceivers into Participant pockets.

Pairing Button – Create a *ListenTALK Group* by momentarily pressing the Docking Station *Pairing Button*. The *Pairing Indicator* will flash during pairing, then turn solid momentarily and finally extinguish when the pairing process is completed successfully. Create multiple, independent ListenTALK Groups by repeating this process with additional units.



Note: Each ListenTALK Group is independent and communication is secured by a unique Pair Key.

Note: To prevent heat build up keep lid open when connected to power!

ListenTALK Docking Station Quick Start Guide

New Pair Key – To create a new Pair Key, insert Leader into Leader pocket and other transceivers into Participant pockets in the Docking Station. Press and hold the Pairing Button for 5 seconds. The Pairing and Status Indicators will flash momentarily, turn solid and then extinguish indicating success.

Leader Clip Storage

Leader Clips are only required for Leader and Sub-Leader Transceivers. Remove Leader Clips from Participant Transceivers and place them in the Docking Station *Leader Clip Storage* slots for future use.

ListenTALK Status



Status Button – Press and hold the Docking Station *Status Button* to illuminate the Transceiver *Graphic Displays* for Group identification and other Transceiver information.

LA-382 Intelligent Cable Management Unit

A *Cable Management Unit* is available for convenient storage of headset accessories (available for use with Docking Station 16 only).



User Check-Out/Identification

Docking Station Pockets – Place a credit-card sized I.D. in the Docking Station Pocket to identify the person currently using that specific ListenTALK Transceiver.

ListenTALK Software Suite – Use *Check-Out Mode* to identify the person currently using a specific ListenTALK Transceiver.

Programming

Connect a Windows PC to the Docking Station USB port. Download and install the *ListenTALK Software Suite* from www.listentech.com/support/software. For software operation details, consult the software help files.

Docking Station Tray Top and Bottom

(Mounting Slots and Handles are not Accessible on Docking Station Case)

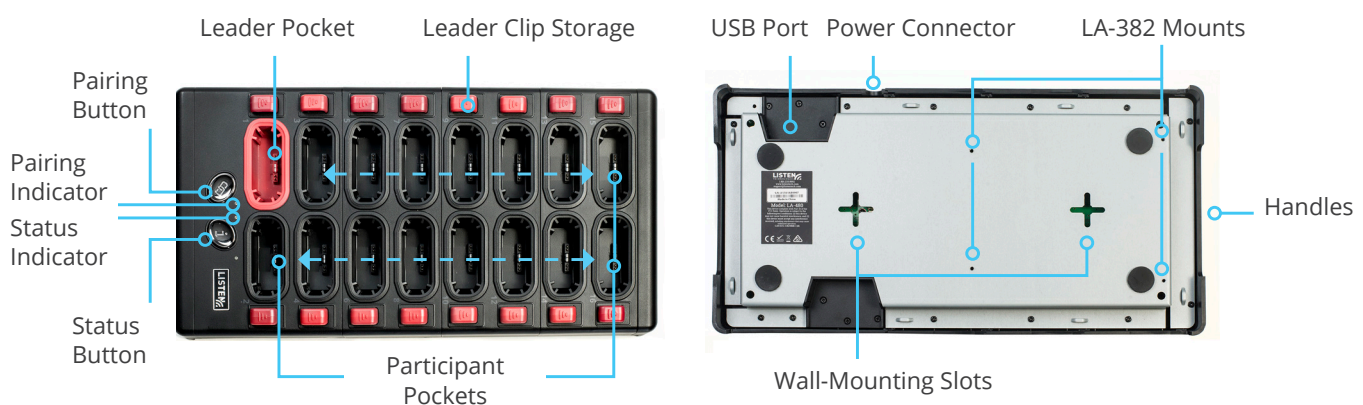

LISTEN TECHNOLOGIES 14912 Heritage Crest Way, Bluffdale, Utah 84065-4818 USA

Phone: +1.801.233.8992 Toll-Free: 1.800.330.0891 www.listentech.com

Copyright © 1998 - 2017 Listen Technologies Corporation. All rights reserved. 20171019